

Female Adapter

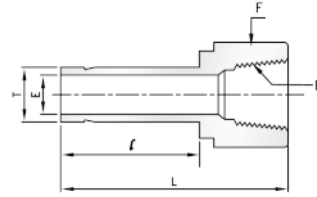

Dimensions:

Part No.	Tube O. D. T in	P* (NPT)	E min.	Width across flat	l	L
				F in		
S1-400-02-02	1/8	1/8	1.77	9/16	13.45	31.50
S1-400-02-04	1/8	1/4	1.77	3/4	13.45	35.30
S1-400-03-02	3/16	1/8	3.04	9/16	14.20	32.00
S1-400-03-04	3/16	1/4	3.04	3/4	14.20	35.81
S1-400-04-02	1/4	1/8	4.57	9/16	15.75	33.02
S1-400-04-04	1/4	1/4	4.57	3/4	15.75	37.10
S1-400-04-06	1/4	3/8	4.57	7/8	15.75	39.37
S1-400-04-08	1/4	1/2	4.57	1-1/16	15.75	42.50
S1-400-05-02	5/16	1/8	6.35	9/16	16.80	34.29
S1-400-05-04	5/16	1/4	6.35	3/4	16.80	37.59
S1-400-06-02	3/8	1/8	7.11	9/16	17.50	34.29
S1-400-06-04	3/8	1/4	7.11	3/4	17.50	38.10
S1-400-06-06	3/8	3/8	7.11	7/8	17.50	40.38
S1-400-06-08	3/8	1/2	7.11	1-1/16	17.50	46.73
S1-400-08-04	1/2	1/4	9.90	3/4	23.20	43.43
S1-400-08-06	1/2	3/8	9.90	7/8	23.20	45.46
S1-400-08-08	1/2	1/2	9.90	1-1/16	23.20	51.80
S1-400-10-06	5/8	3/8	12.70	7/8	24.70	48.26
S1-400-10-08	5/8	1/2	12.70	1-1/16	24.70	53.84
S1-400-10-12	5/8	3/4	12.70	1-1/4	24.70	55.37
S1-400-12-08	3/4	1/2	14.98	1-1/16	24.70	52.83
S1-400-12-12	3/4	3/4	14.98	1-1/4	24.70	54.86
S1-400-12-16	3/4	1	14.98	1-5/8	24.70	58.42
S1-400-14-12	7/8	3/4	17.27	1-1/4	26.70	57.15
S1-400-16-12	1	3/4	20.06	1-1/4	31.70	60.70
S1-400-16-16	1	1	20.06	1-5/8	31.70	64.26

All dimensions are in millimeters unless otherwise specified. Dimensions are for reference only, subject to change.

Another Quality Product By: Unique Valves & Instrumentation.