

SEATING NIPPLES

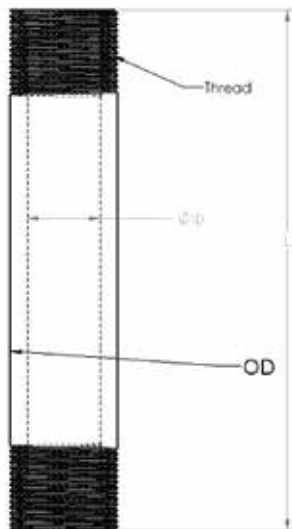

Specification:

- **Material of Seating Nipples :**
J55 as per API 5CT standard.
- **Threads sizes of Seating Nipples :**
10Rd for 1 1/2" NUE 1 1/2" EUE and 8Rd for 2 3/8" and 2 7/8" EUE as per API 5B standard



Item ID	SIZE	L	OD	ID	Thread
SN1.50X1210RDEUE	1 1/2"	12	2.12	1.47	1 1/2" EUE 10Rd
SN2.375X128RDEUE	2"	12	2.6	1.78	2" EUE 8Rd
SN2.875X128RDEUE	2 1/2"	12	3.1	2.28	2 1/2" EUE 8Rd
SN1.50X1210RDNUE	1 1/2"	12	1.9	1.47	1 1/2" NUE 10Rd

* Due to the continuous development of our products, design or construction may change without prior notice.