

# GROOVED FITTINGS

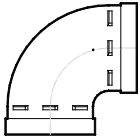

Style 002L 90° Std. Elbow  
Page 43



Style 3L 45° Elbow  
Page 43

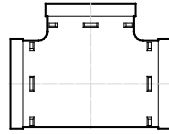

Style 004L Std. Equal Tee  
Page 43

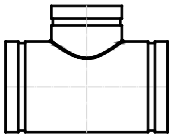

Style 011L Std. Reducing Tee(G)  
Page 46/48

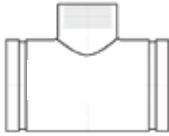

Style 012L Std. Reducing Tee(T)  
Page 46/48

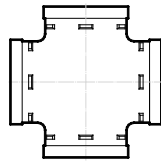

Style 010L Std. Equal Cross  
Page 43

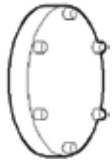

Style 5L End Cap  
(plate)  
Page 43



Style 005WH  
End Cap with Cap  
Page 51

- Designed by CAD and Finite Element Analysis, with advanced structure and high safety factor.
- The minimum inner diameter is maximized when design. It provides excellent flow character.
- Served in variable curvature radii, include short, standard and big radii types.
- Short type fittings have same rated working pressure as Style 001 Standard Rigid Couplings.
- Standard type fittings have same rated working pressure as Style 101H HD Flexible Couplings.
- All grooved ends on all fittings are standard machined cut grooves.
- Radius of short type is equal to 0.75D, standard type with 1.0D.



## Specification:

### GROOVED FITTINGS

#### Coupling Housing:

Material D.I. ASTM – A536, Grade 65- 45-12

#### Nuts & Bolts:

Conform to ASTM A- 183 and plated to ASTM B – 633

#### Fittings:

Material D.I. to ASTM A-536, Grade 65 -45 -12

# GROOVED FITTINGS

## Standard Radius Series

Style 002L 90° Std. Elbow

Style 3L 45° Elbow

Style 004L Standard Equal Tee

Style 5L End Cap (plate)

Style 010L Standard Equal Cross



Size		002L 90° Std. Elbow		3L # 45° Elbow		004L Std. Tee Equal		5L § End Cap		010L <sup>sw</sup> Std. Cross Equal	
Nominal Dia.	Actual O.D.	CE	Approx. Wgt.	CE	Approx. Wgt.	CE	Approx. Wgt.	CE	Approx. Wgt.	CE	Approx. Wgt.
DN	mm	mm	kg	mm	kg	mm	kg	mm	kg	mm	kg
Inches	Inches	Inches	Lbs.	Inches	Lbs.	Inches	Lbs.	Inches	Lbs.	Inches	Lbs.
20	26.7	57	0.3	38	0.2	57	0.3	23	0.1	57	0.4
¼	1.050	2.25	0.7	1.50	0.5	2.25	0.6	0.90	0.2	2.25	0.8
25	33.4	57	0.4	44	0.3	57	0.5	23	0.1	57	0.7
1	1.315	2.25	0.9	1.75	0.7	2.25	1.2	0.90	0.2	2.25	1.5
32	42.4	70	0.5	44	0.3	70	0.7	23	0.1	70	0.9
¼	1.660	2.75	1.1	1.75	0.7	2.75	1.5	0.90	0.2	2.75	2.0
40	48.3	70	0.6	44	0.4	70	0.8	23	0.2	70	1.1
½	1.900	2.75	1.3	1.75	0.9	2.75	1.8	0.90	0.4	2.75	2.4
50	60.3	83	0.9	51	0.6	83	1.2	25	0.2	83	1.7
2	2.375	3.25	2.0	2.00	1.3	3.25	2.6	1.00	0.4	3.25	3.7
65	73.0	95	1.4	57	0.9	95	1.9	25	0.3	95	3.1
2½	2.875	3.75	3.1	2.25	2.0	3.75	4.1	1.00	0.7	3.75	6.8
65	76.1	95	1.4	57	0.9	95	1.9	25	0.3	95	3.2
300	3.000	3.75	3.1	2.25	2.0	3.75	4.1	1.00	0.7	3.75	7.1
80	88.9	108	1.8	64	1.0	108	2.5	25	0.3	108	4.6
3	3.500	4.25	4.0	2.75	2.2	4.25	5.3	1.00	0.7	4.25	10.1
100	108.0*	127	3.1	76	1.7	127	4.1	25	0.4	127	7.3
4¼OD	4.250	5.00	6.8	3.00	3.7	5.00	9.1	1.00	0.9	5.00	16.1
100	114.3	127	3.2	76	1.7	127	4.3	25	0.5	127	7.8
4	4.500	5.00	7.1	3.00	3.7	5.00	9.4	1.00	1.1	5.00	17.2
125	133.0*	140	4.7	83	2.5	140	6.3	25	0.7	140	10.8
5¼OD	5.250	5.50	10.4	3.25	5.5	5.50	13.8	1.00	1.5	5.50	23.8
125	139.7	140	4.9	83	2.6	140	6.2	25	0.9	140	11.4
5½OD	5.500	5.50	10.8	3.25	5.7	5.50	14.4	1.00	2.0	5.50	25.1
125	141.3	140	5.0	83	2.6	140	6.2	25	0.9	140	11.6
5	5.563	5.50	11.0	3.25	5.7	5.50	14.7	1.00	2.0	5.50	25.6
150	159.0*	165	6.8	89	3.8	165	9.0	25	1.3	165	16.5
6¼OD	6.250	6.50	15.0	3.50	8.4	6.50	19.9	1.00	2.9	6.50	36.4
150	165.1	165	7.0	89	3.9	165	9.3	25	1.1	165	17.1
6½OD	6.500	6.50	15.4	3.50	8.6	6.50	20.5	1.00	2.4	6.50	37.7
150	168.3	165	7.0	89	4.0	165	8.9	25	1.3	165	17.7
6	6.625	6.50	15.4	3.50	8.8	6.50	20.5	1.00	2.9	6.50	39.0
200	219.1	197	12.0	108	7.2	197	17.2	31	3.8	197	31.9
8	8.625	7.75	26.5	4.25	15.9	7.75	35.2	1.22	8.4	7.75	70.3
250	273.0	229	20.0	121	14.3	229	28.0	31	6.4	229	52.5
10	10.750	9.00	44.1	4.75	31.5	9.00	58.6	1.22	14.1	9.00	115.7
300	323.9	254	29.0	133	22.0	254	40.0	31	9.0	254	77.0
12	12.750	10.00	63.9	5	48.5	10.00	85.0	1.22	19.8	10	169.8

# Style 3L and Style 003 share the same product.  
 § Style 5L and Style 005 share the same product.  
 sw Style 010L Std. Cross Equal is segmentally welded product. Unit weight is calculated by carbon steel pipe with cut grooved ends.  
 \* DIN and GB sizes.