

# FRAC TANK EXTERNAL MANIFOLD

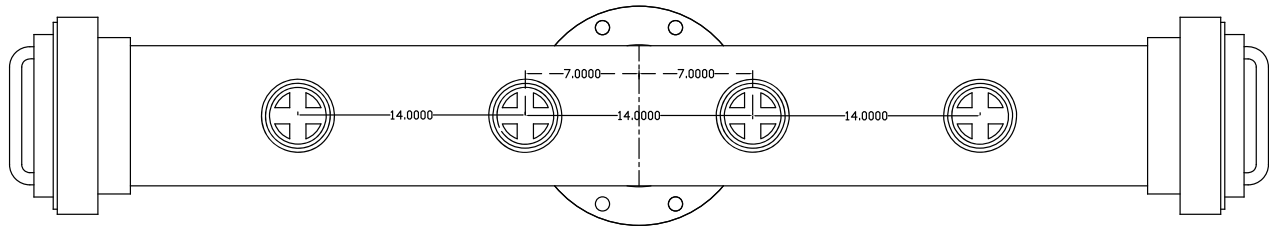

## Specification:

### Frac Tank External Manifold

- 2 - 8" External WECO Style Frac Ports
- 2 - 8" Hammer Unions Subs & Caps
- 4- 4" Front Connection Ports with 4" CLASS 150 Plugs
- Capacity: 16 gallons
- Length: Available in 6' & 5' (Frac Nut to Frac Nut)
- 8" Slip On Flanges-ANSI B16.5 Class 150 lb.
- Working pressure: 150 PSI
- Inlet pipe: 8" Sch. 40

### Standards

- Pressure Vessels: ASME Section VIII - Division 1
- Piping: American Society of Mechanical Engineers - ASME B3.1.1 / 31.3/ 31.8
- Welding Qualifications: ASME Section IX
- Welding Technologies: SMAW
- Frac Nuts: ASTM A216 WCB.
- Plugs & Frac Cap: ASTM A536 DI 65-45-12
- Flange: ASTM 1045 Carbon steel

\* Due to the continuous development of our products, design or construction may change without prior notice.