

# STACK VENT VALVES

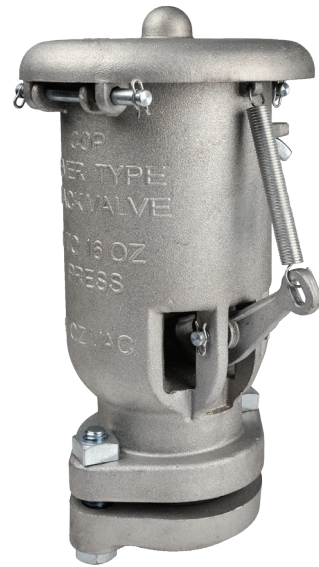

## Specification:

### End Of Line Stack Vent Valve

The End of Line Stack Vent Valve is installed at the end of the vent line exhaust to minimize the escape of light ends of crude in storage by maintaining a pressure on the tank. The pressure vacuum vent valve opens when the system pressure or vacuum surpasses the set pressure of the valve. Upon over pressure conditions, the weighted pallet lifts and breaks away the seal between seat and pallet, allowing the release of vapors and relieving the pressure or vacuum buildup.

- Complete high-tensile-strength aluminum body, lid, and flange.
- All internal working components are made of superior plastic material with the operating range from -50°F to 500°F.
- Full-opening lid and large body cavity for easy clean-out and maintenance.
- Slip-in pressure seat for easy replacement in the shop or the field - vacuum seat replacement is even easier.
- Internal plunger with a built-in vacuum breaker for the pressure-vacuum valve.
- Available in 2" & 3" slip-on flanges with standard settings of 1.5 oz pressure and 0.4 oz vacuum with additional weights available in 1-oz increments.

\* Due to the continuous development of our products, design or construction may change without prior notice.

# STACK VENT VALVES

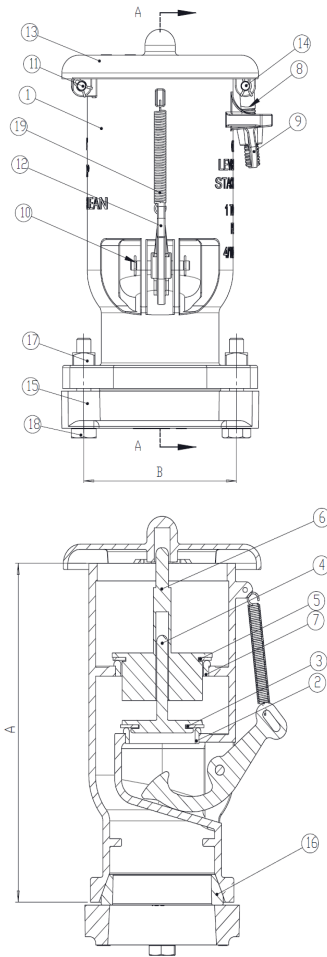

19	Spring	Φ1.35 Steel	1	
18	Bolt 1/2-13	Steel	2	3"
17	Square nut	Steel	2	
16	3" flange gasket	Buna	1	
15	3" Flange	ZL102	1	
14	Pin	Steel	2	
13	Cap	ZL102	1	
12	Test lever	ZL102	1	
11	Pin	Steel	1	
10	Retainer clip	Steel	6	
9	Wing Nut 1/2	Steel	1	
8	Al bolt	1060	1	
7	Pressure seat	PPS	1	
6	Pressure disc	PPS	1	
5	Pressure gasket	Buna	1	
4	Vacuum disc	PPS	1	
3	Vacuum gasket	Buna	1	
2	Vacuum seat	PPS	1	
1	Valve body	ZL102	1	
Ser #	Part Name	Material	Qty.	Remark

## Vent Setting Range:

Model No.	Size	Pressure	Vacuum
2X2STVV	2"	1.0 to 16.0 oz/sq.in. (0.5 Increments)	0.4 oz/sq.in.
3X3STVV	3"		

## Dimension

### Dimensions (IN)

Model No.	Size	A	B
2X2STVV	2"	8.62	4.13
3X3STVV	3"	10.51	5.35