

# CARBON STEEL SEAL WELD BALL VALVE

## SERIES: 2006WCW



### Specification:

#### Carbon Steel Seal Weld Ball Valve

- Full PORT
- 2000 W.O.G.
- 2 PIECE CAST BODY W/ MOUNTING PAD
- NACE APPROVED
- BLOW OUT PROOF STEM
- PTFE/RPTFE SEAL AND PACKING
- THREADS CONFORM TO ASME B1.20.1 (NPT)

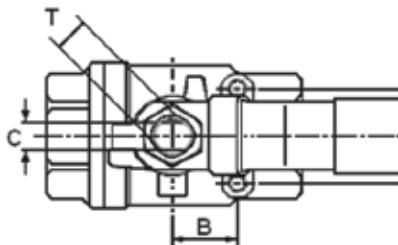
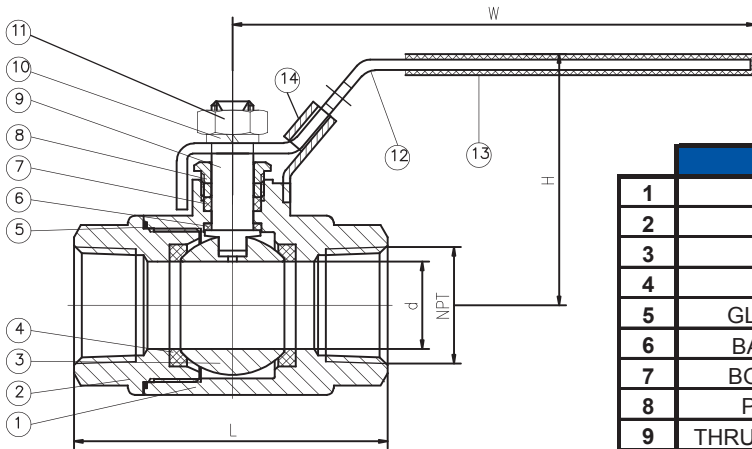
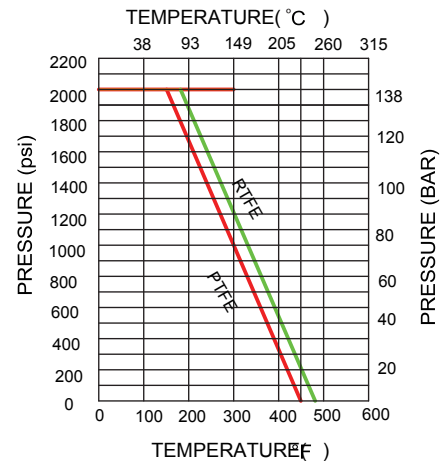

| PART | MATERIAL      |                              |
|------|---------------|------------------------------|
| 1    | BODY          | ASTM A216-WCB (CARBON STEEL) |
| 2    | CAP           | ASTM A351-CF8M (316SS)       |
| 3    | BALL          | ASTM A351-CF8M (316SS)       |
| 4    | STEM          | ASTM A276-316                |
| 5    | GLAND NUT     | AISI 304                     |
| 6    | BALL SEAT     | PTFE/RPTFE                   |
| 7    | BODY SEAL     | PTFE                         |
| 8    | PACKING       | PTFE/RPTFE                   |
| 9    | THRUST WASHER | PTFE                         |
| 10   | SPRING WASHER | AISI 304                     |
| 11   | STEM NUT      | AISI 304                     |
| 12   | HANDLE        | AISI 304                     |
| 13   | HANDLE SLEEVE | PVC                          |
| 14   | LOCK DEVICE   | AISI 304                     |

| SIZE            | 1/4"  | 3/8"  | 1/2"  | 3/4"  | 1"    | 1-1/4" | 1-1/2" | 2"    |
|-----------------|-------|-------|-------|-------|-------|--------|--------|-------|
| d               | 0.429 | 0.492 | 0.591 | 0.787 | 0.984 | 1.260  | 1.496  | 1.969 |
| L               | 2.461 | 2.461 | 2.461 | 3.051 | 3.543 | 3.937  | 4.646  | 5.413 |
| H               | 2.283 | 2.362 | 2.362 | 2.480 | 2.835 | 3.110  | 3.622  | 4.134 |
| W               | 4.331 | 4.724 | 4.724 | 4.724 | 5.906 | 5.906  | 7.087  | 7.087 |
| B               | 0.55  | 0.55  | 0.55  | 0.86  | 0.86  | 0.94   | 0.94   | 0.94  |
| C               | 0.19  | 0.19  | 0.19  | 0.25  | 0.31  | 0.31   | 0.35   | 0.35  |
| T               | 0.3   | 0.3   | 0.3   | 0.37  | 0.42  | 0.42   | 0.49   | 0.49  |
| Torque (ft-lbs) | 3     | 3     | 4.4   | 7.37  | 14    | 20.6   | 33.2   | 44.25 |
| Weight          | 0.7   | 0.7   | 1.15  | 1.75  | 2.2   | 4      | 5      | 8.2   |

\* Due to the continuous development of our products, design or construction may change without prior notice.